

The Village at James Creek

Statement of Landscape Intent

Prepared For:
MPD Investments Pty Ltd



Australia
China
South East Asia

Follow us on



placedesigngroup.com

Project	The Village at James Creek
Report title	Statement of Landscape Intent
Document number	230219
Prepared for	MPD Investments Pty Ltd
Authors	Naomi Cole
Revision number	J
Revision issue date	12 JULY 2024
Approved	Peter Bell, Clint Wood
Reason for revision	Development Application

Disclaimer: This report has been prepared in accordance with the scope of services described in the contract or agreement between Place Design Group Pty Ltd ACN 082 370063 and the Client. The report relies upon data, surveys, measurements and results taken at or under the particular times and conditions specified herein. Any findings, conclusions or recommendations only apply to the aforementioned circumstances and no greater reliance should be assumed or drawn by the Client. Furthermore, the report has been prepared solely for use by the Client and Place Design Group accepts no responsibility for its use by other parties.

01

SITE CONTEXT

- 1.1 Location
- 1.2 Site Photos

04

02

LANDSCAPE DESIGN

- 2.1 Landscape Masterplan
- 2.2 Circulation & Recreational Analysis

07

03

DETAIL DESIGN

- 3.1 Detail Plan 1 - Entrance
- 3.2 Detail Plan Entrance - Section
- 3.3 Detail Plan 2 - Village Green
- 3.4 Detail Plan 3 - Entry Parkland
- 3.5 Community Facilities
- 3.6 Detail Plan 4 - Southwest Biobasin
- 3.7 Detail Plan 5 - Eastern Biobasins
- 3.8 Biobasin Character Images
- 3.9 Fences
- 3.10 Retaining Walls

10

04

SECTIONS

- 4.1 Northern Boundary
- 4.2 Southern Boundary
- 4.3 Western Boundary
- 4.4 Austons Lane
- 4.5 Austons Lane continued
- 4.6 James Creek Road

22

05

PLANTING

- 5.1 Street
- 5.2 Park Trees
- 5.3 Park Shrub & Groundcover
- 5.4 Southern Batter to Austons Lane
- 5.5 Biobasin
- 5.6 Bushfire Protection Zone Trees
- 5.7 Bushfire Protection Zone Shrub & Groundcover

29

- 30
- 31
- 32
- 33
- 34
- 35
- 36



01

SITE CONTEXT

SITE CONTEXT

1.1 Location

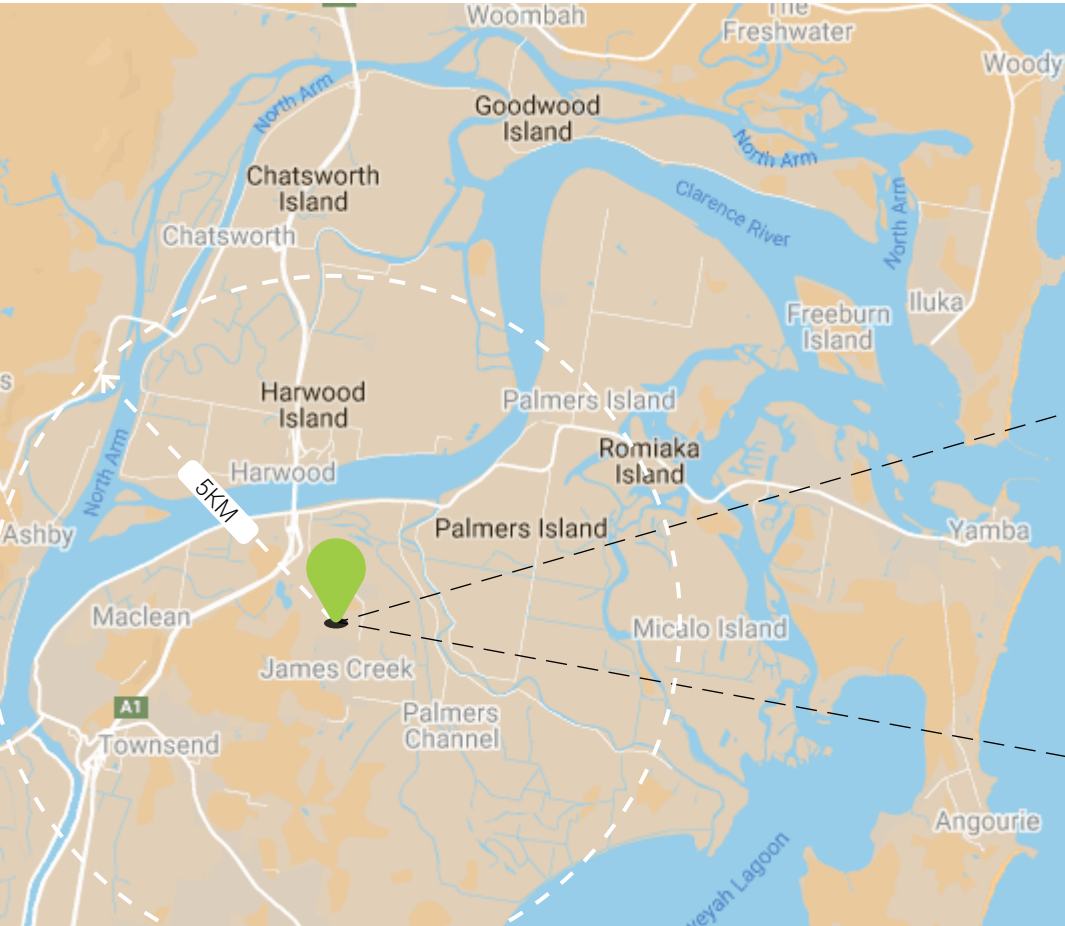

James Creek



01 View from James Creek Road



02 View from James Creek Road



03 View from James Creek Road



04 View from Austons Lane



Key Plan



02

OVERALL LANDSCAPE DESIGN



OVERALL LANDSCAPE DESIGN

2.2 Circulation & Recreational Analysis

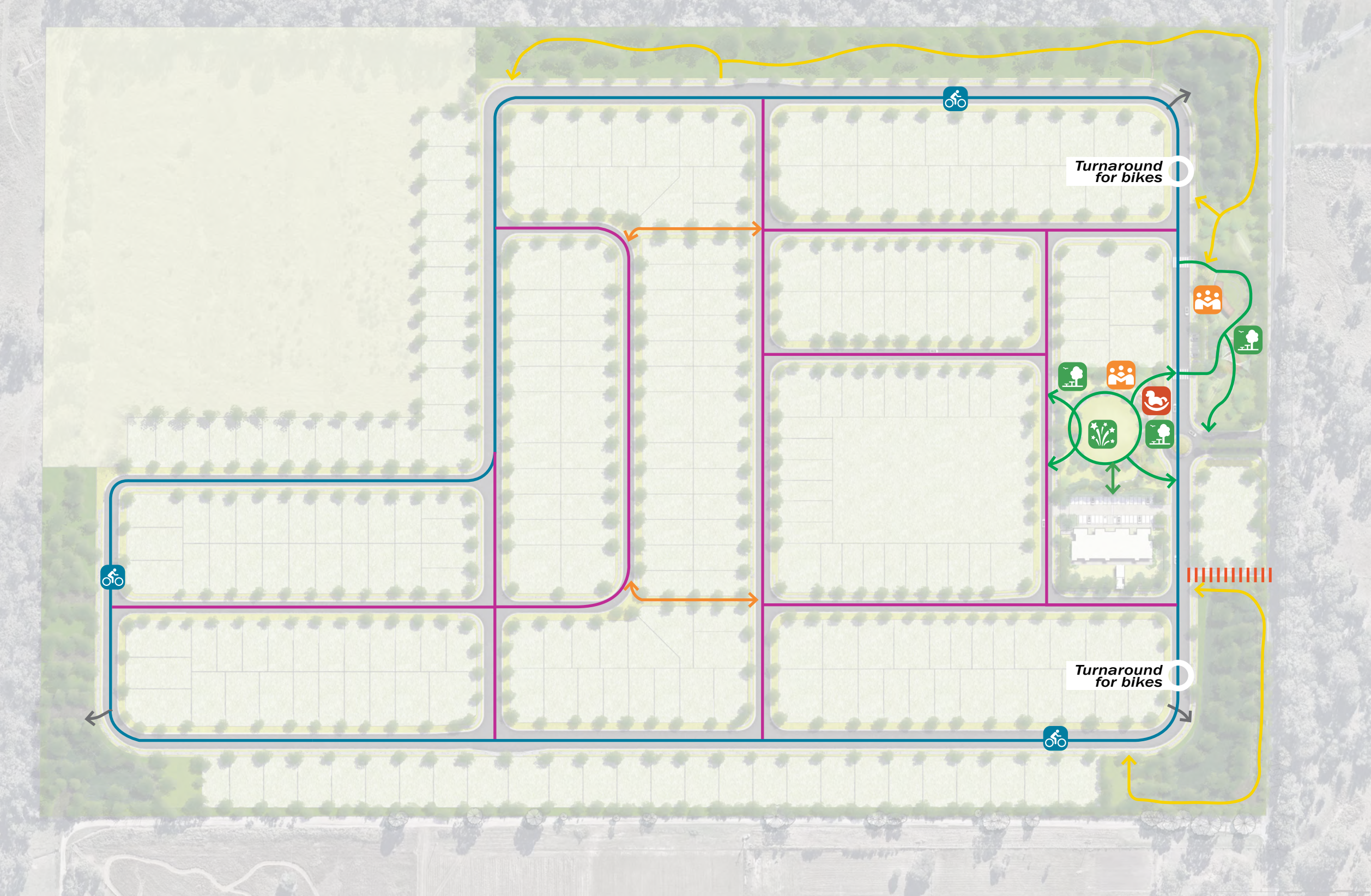

- Legend
- Perimeter shared path for pedestrian & bike
 - Community footpath
 - Informal footpath/ circulation
 - Pedestrian linkage between lots
 - Parkland path
 - Gated Maintenance Access to Bio-basin
 - Emergency linkage
 - Community open space
 - Playground
 - Village green
Event lawn
 - Seating & rest

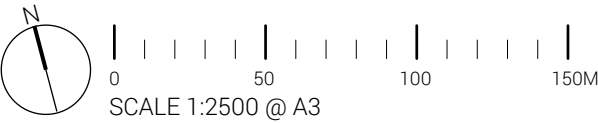



03

DETAIL DESIGN

DETAIL DESIGN

3.1 Detail Plan 1 - Entrance



- 01 Planted entry with boulevard trees
- 02 Pedestrian crossing linking parks and lots
- 03 Central island with low level planting to maintain sightlines
- 04 Planted mounding to frame entry view
Opportunity for low level entry feature/ signage
- 05 Shared path for pedestrian & bike recreation
- 06 Shade tree and low planting in roundabout to maintain sightlines

DETAIL DESIGN

3.2 Detail Plan 1 - Entrance Section

Note:
Refer engineering drawings for detailed information

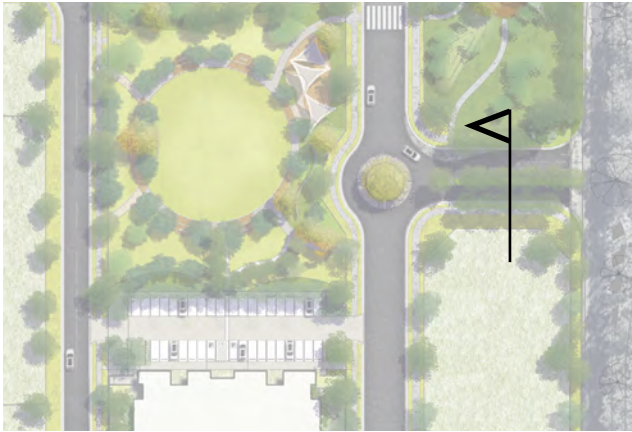

Key Plan

- 01 Buffer planting
- 02 Street tree in planter
- 03 Median with feature boulevard tree
- 04 Estate fence within lots

0 1 2 3 4 5M
SCALE 1:100 @ A3

DETAIL DESIGN

3.3 Detail Plan 2 - Village Green



01 Village green



02 Seating under feature trees



03 Playground
Under shade



04 Swings



05 Spinner Bowl / Carousel



06 Exercise Station



DETAIL DESIGN

3.4 Detail Plan 3 - Entry Parkland



01 Parking to be provided to AS2890



02 Entry feature to entry corner



03 Grassed mounding



04 Shade over BBQ/ Rest Area



05 Community facility
Refer separate page



06 Opportunity for informal gathering area/
amphitheatre



3.5 Community Facilities Character Images

A central feature of the entry park design is the inclusion of a large open structure that can accomodate smaller individual groups as well as large community gatherings.

The structure will be open sided with fixed furniture, with roof enclosure that will provide shade and weather protection.

It will be designed to be a flexible space catering to the estate residents as well as the broader community beyond the site.



3.6 Detail Plan 4 - Southwest Bio basin

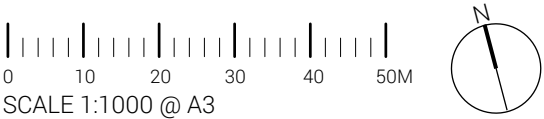
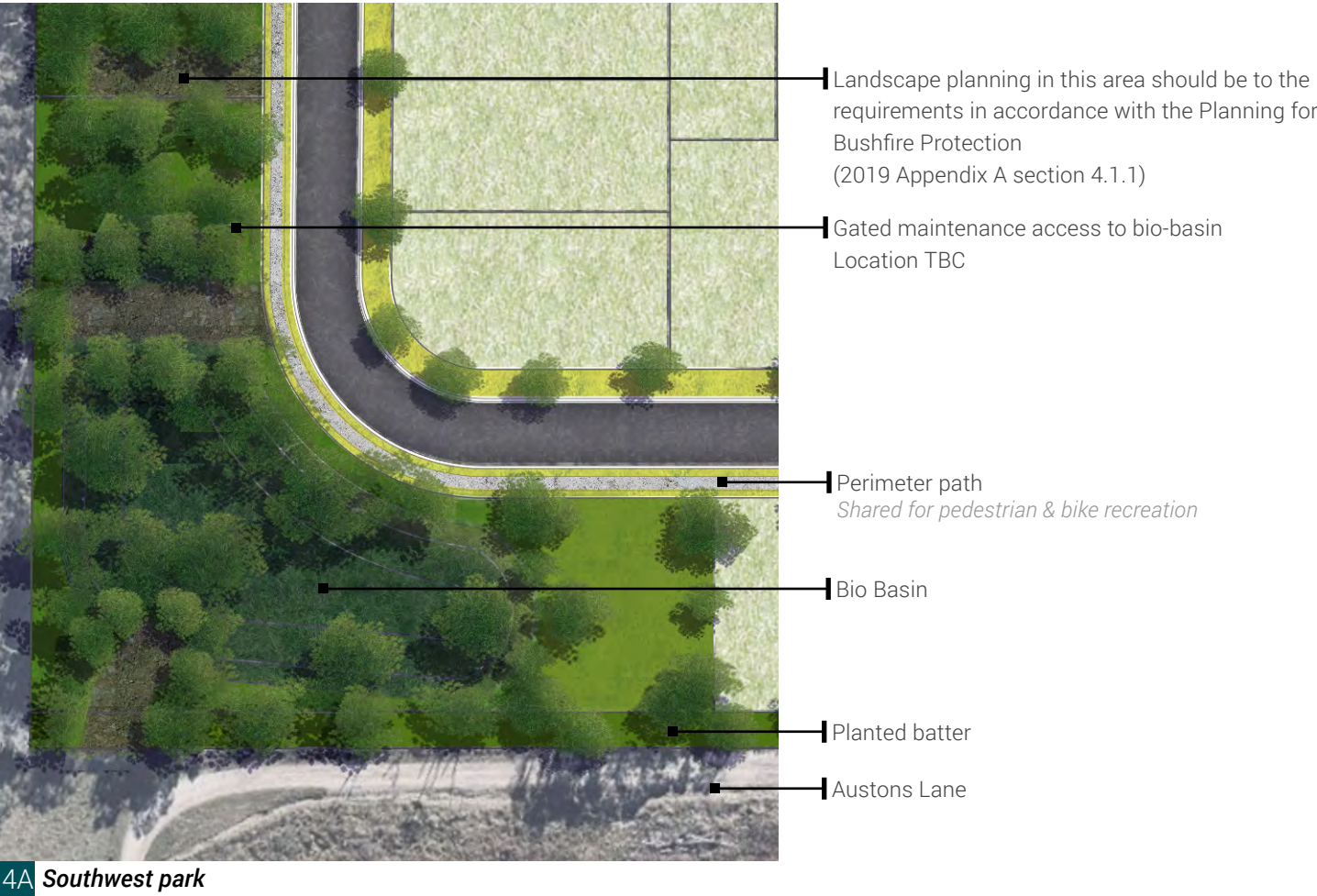

Key Plan

DETAIL DESIGN

3.7 Detail Plans 5 - Eastern Bio basins

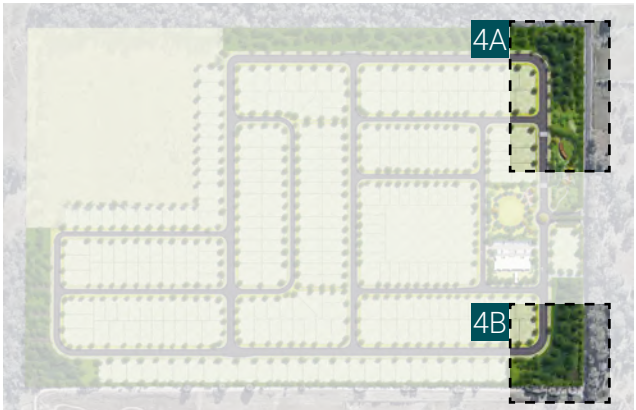
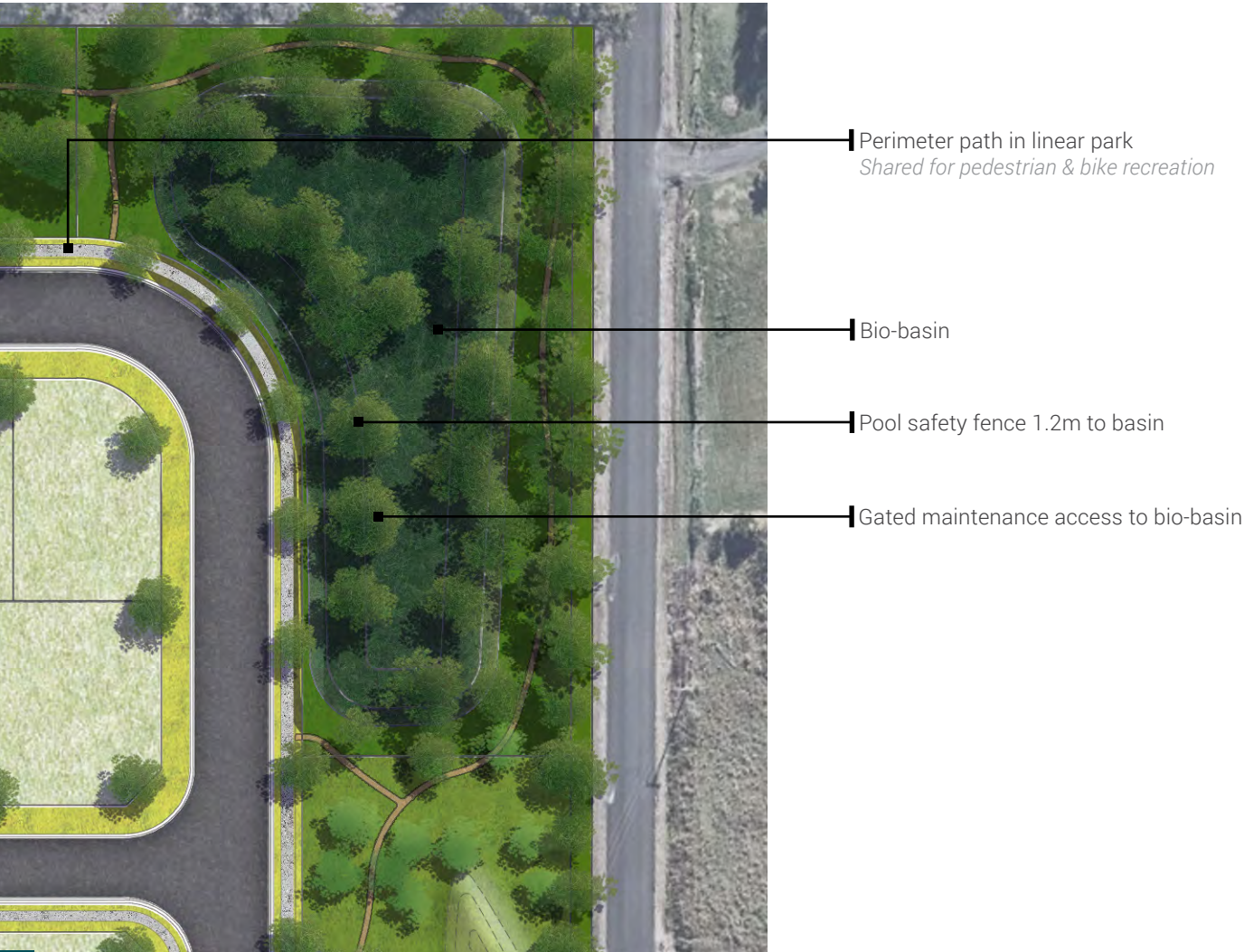

Key Plan





01 Informal walking path



02 Bio Basin



03 Community lawn



- 1.8m High mesh fence to rural neighbouring properties
- Good neighbour fence to Auston's Lane
- Feature fence to James Creek Road
- Feature fence to childcare centre

DETAIL DESIGN

3.10 Retaining Walls - Plan



Maximum retaining locations within lots

Refer typical section

DETAIL DESIGN

3.11 Retaining Walls - Typical Section

Note:
Refer engineering drawings for detailed information

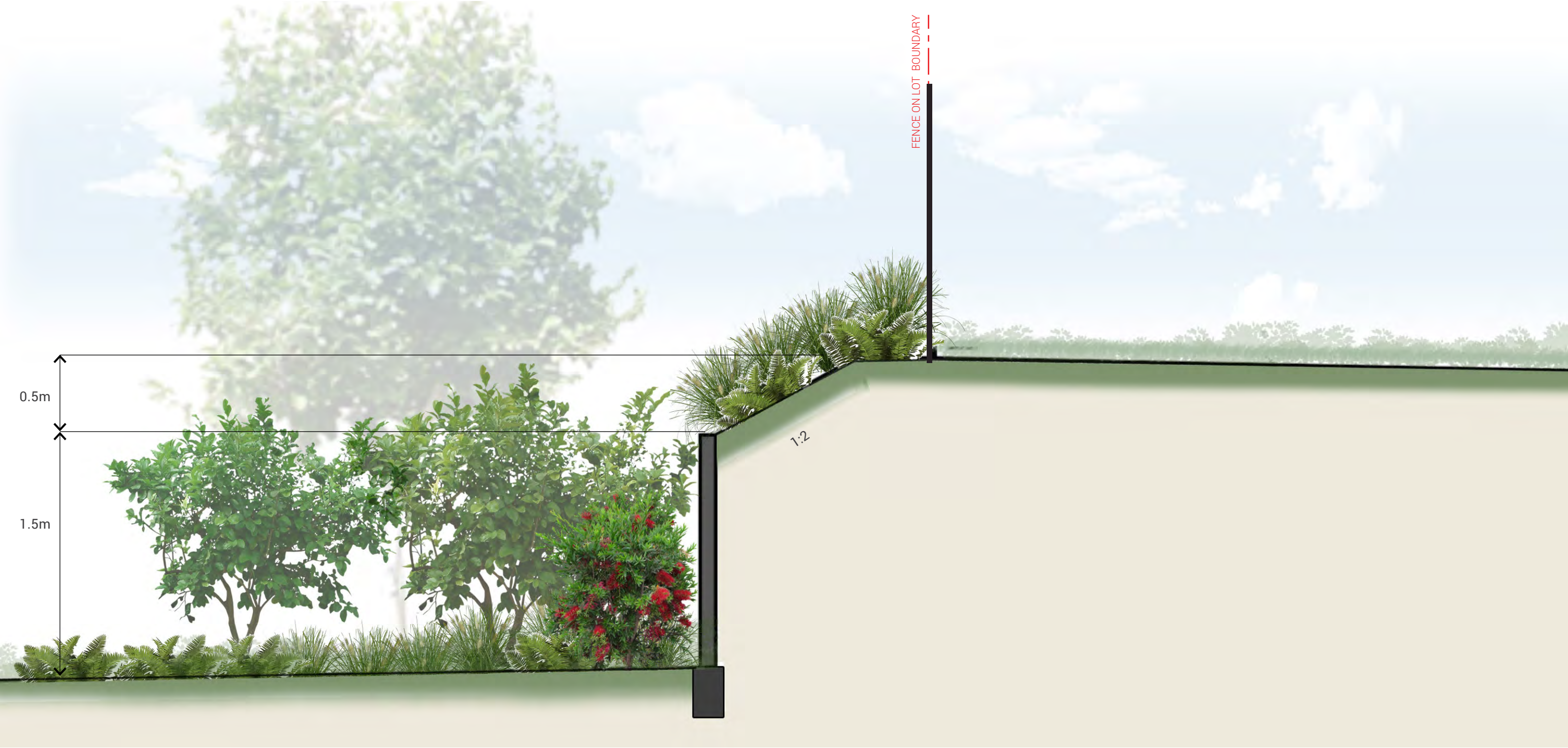

FALL TO THE ROAD FRONTAGE

1m

0.5m

FALL TO THE ROAD FRONTAGE

0 2.5 5 7.5 10 12.5M

SCALE 1:25 @ A3



04

SECTIONS

SECTIONS

4.1 Section 1 - Northern Boundary

Note:
Refer engineering drawings for detailed information

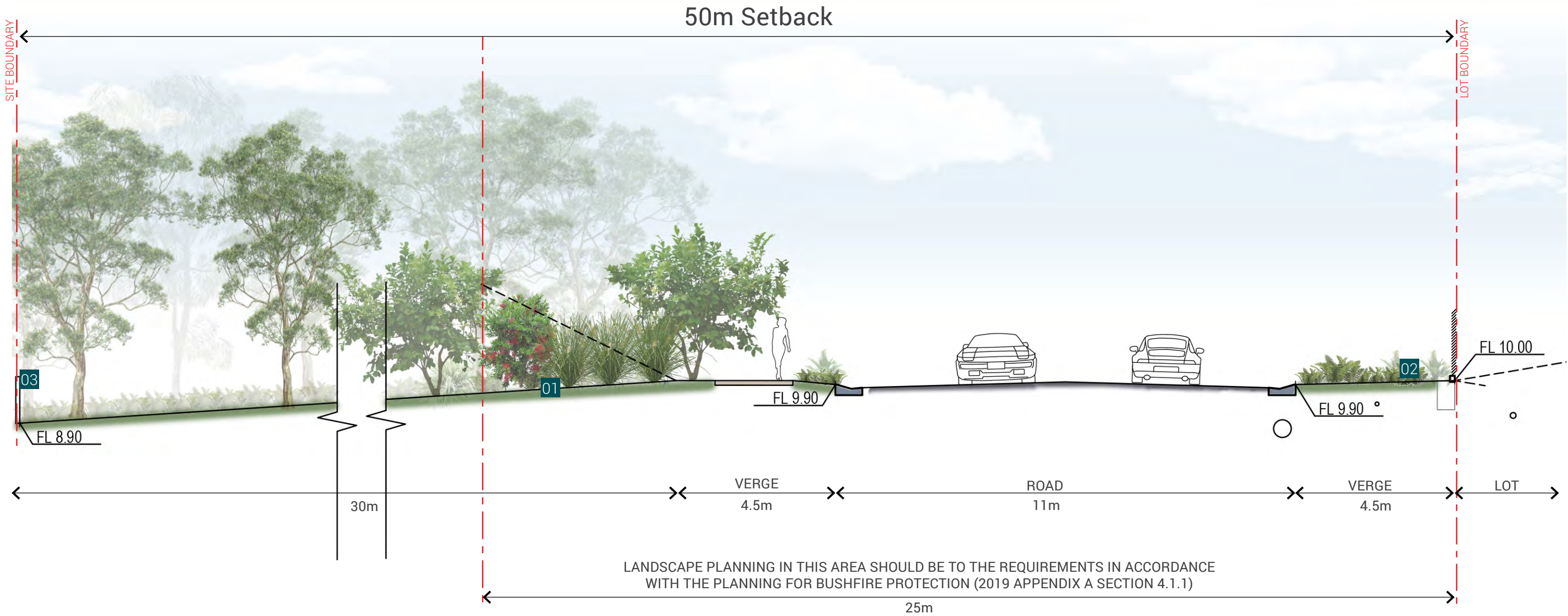

- 01 Batter into existing surface
- 02 Street tree and footpath
- 03 1.8m mesh fence to site boundary within planting

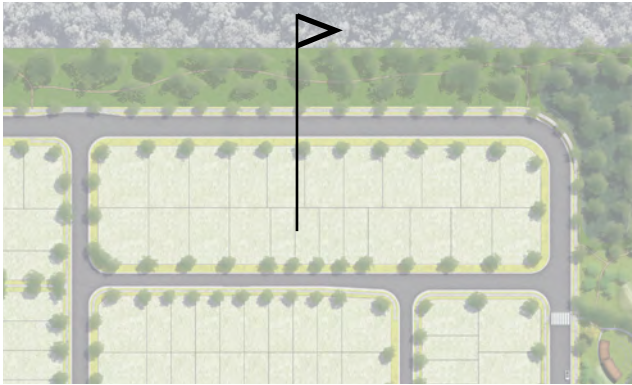

Key Plan



SECTIONS

4.2 Section 2 - Southern Boundary

Note:
Refer engineering drawings for detailed information

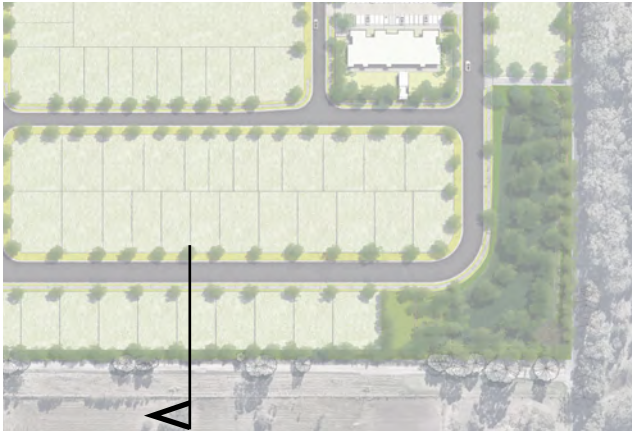
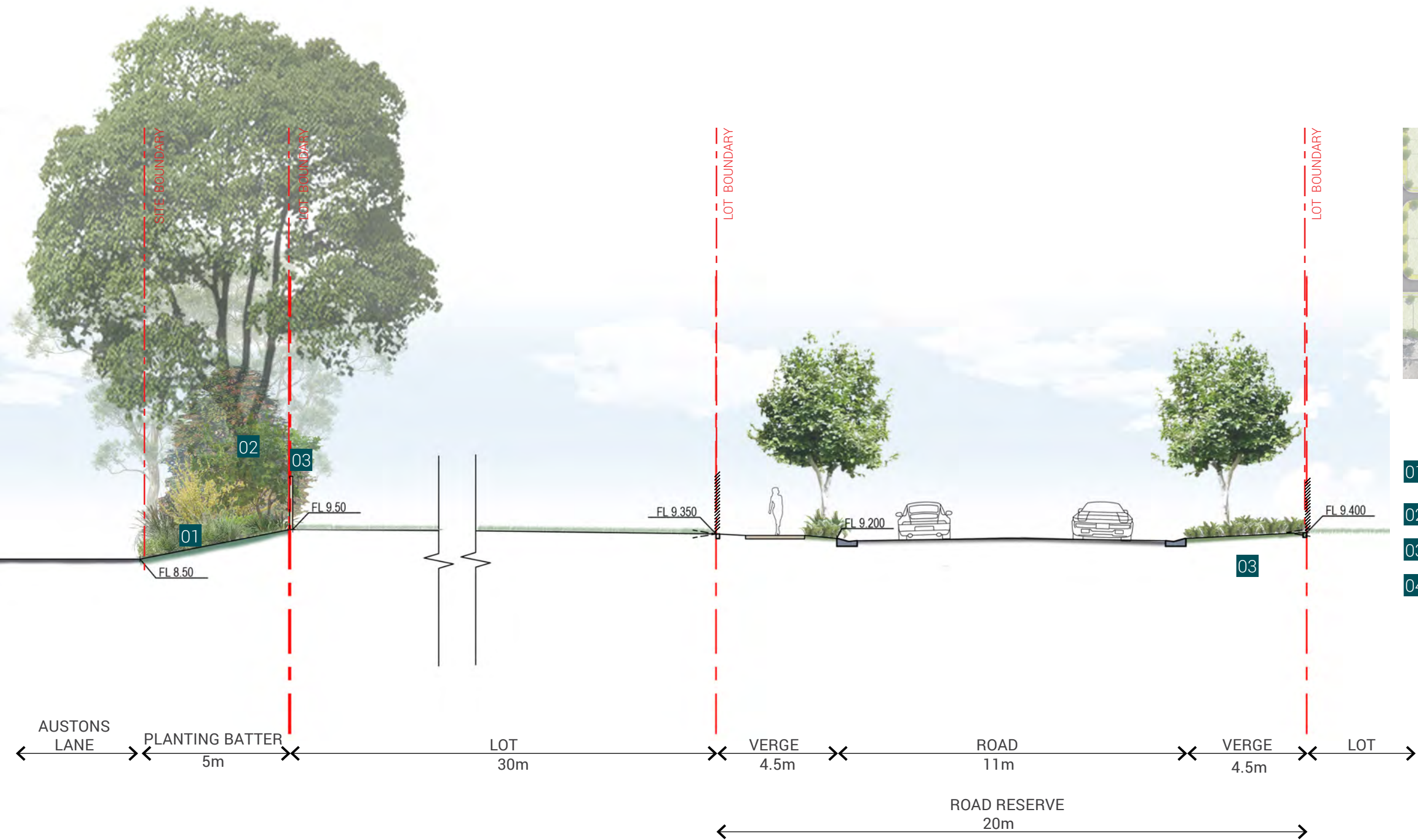

Key Plan

- 01 Batter to existing road with native planting species
- 02 Screening trees and layered planting
- 03 Good neighbour fence to lot boundary
- 04 Street tree and footpath



SECTIONS

4.3 Section 3 - Western Boundary

Note:
Refer engineering drawings for detailed information

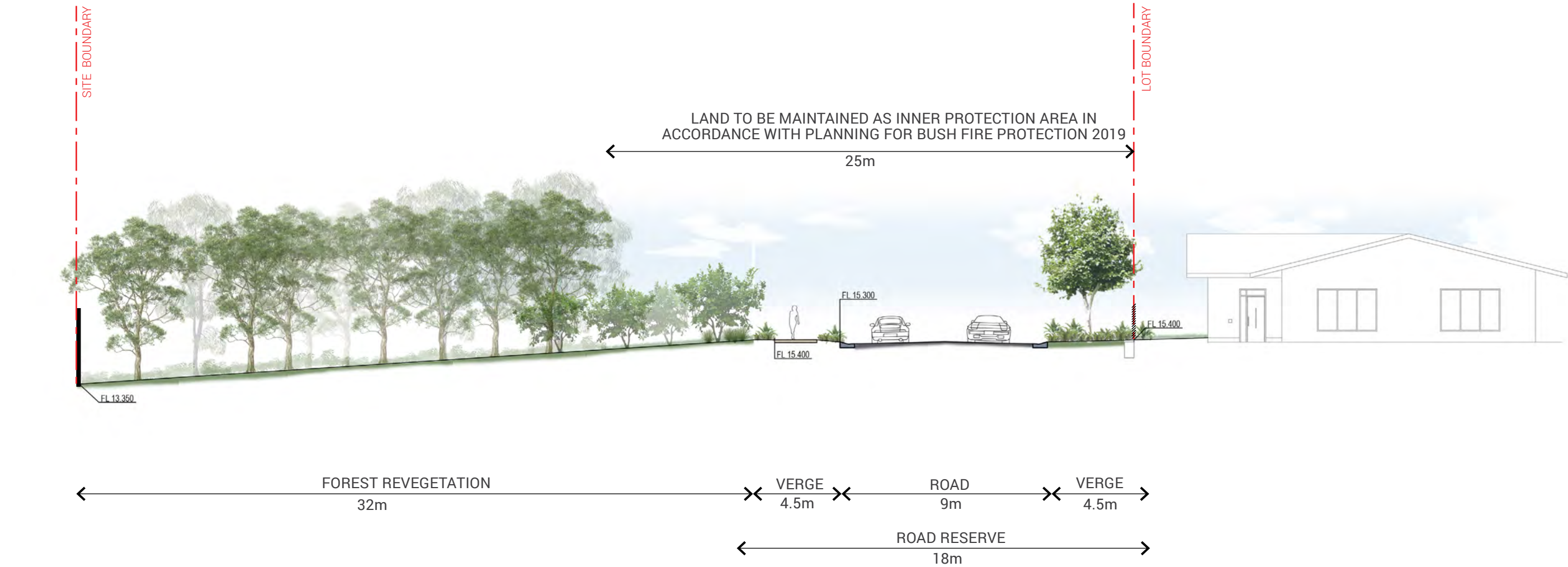

Key Plan

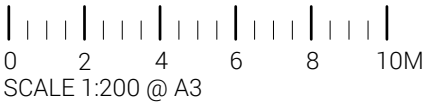

4.4 Section 4 - Planting Batter to Austons Lane

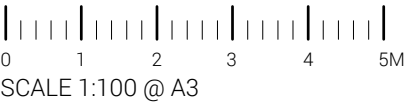
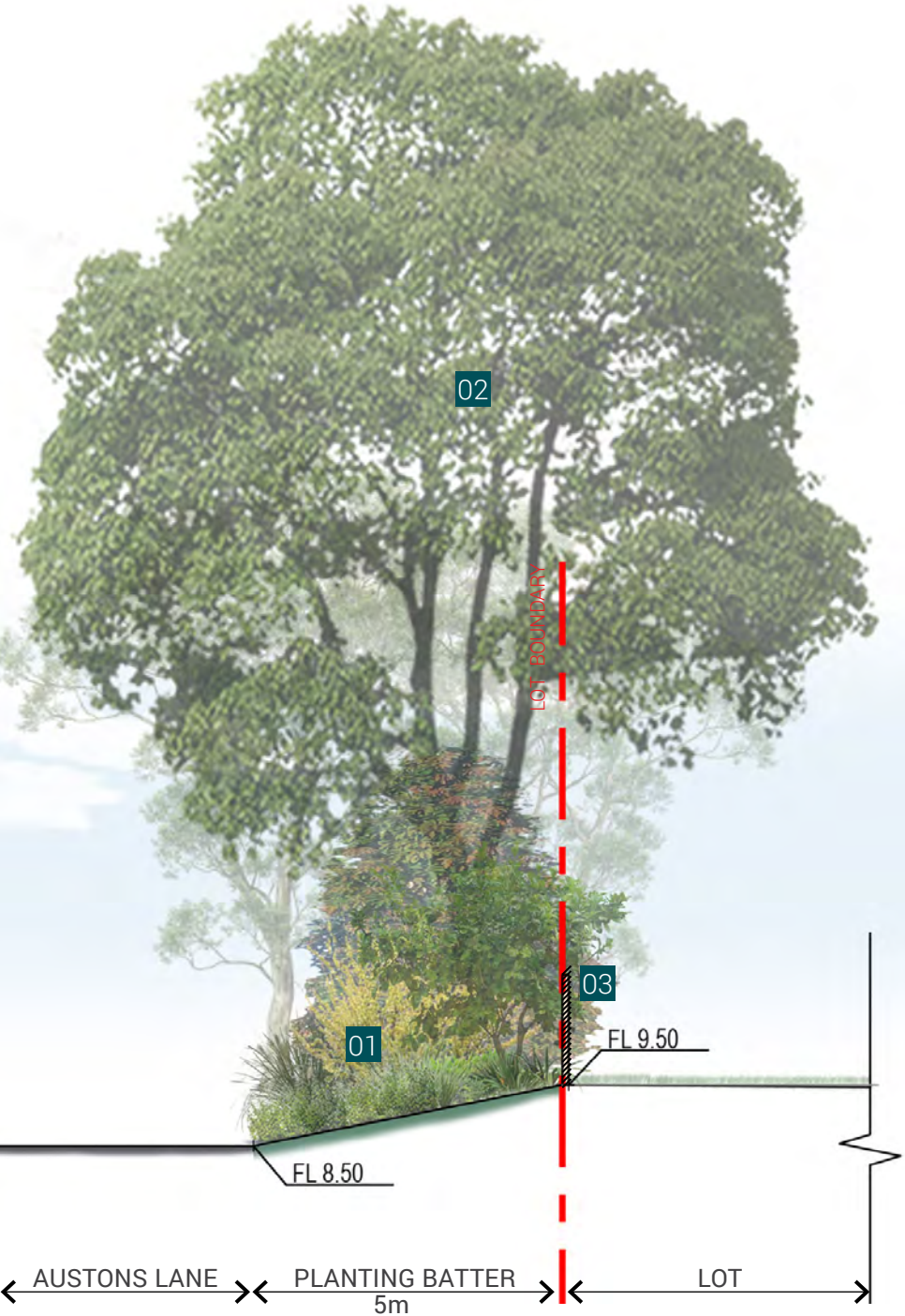

- 01 Planting batter with low maintenance native planting species
- 02 Screening trees
- 03 1.8m high good neighbour fence
- 04 Existing trees to be retained
Individual treatment may be required in front of specific lots

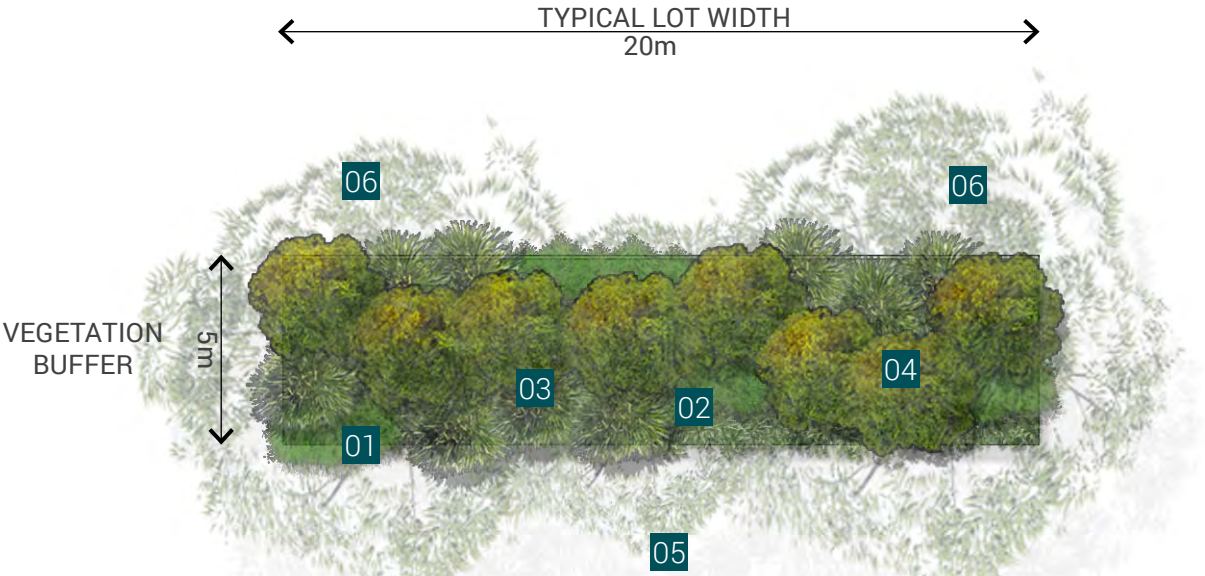

TREES

Botanical Name	Common Name	Mature Size (H x S)
<i>Corymbia citriodora</i>	Spotted Gum	20 x 8m
<i>Cupaniopsis anacardioides</i>	Tuckeroo	8 x 7m
<i>Eucalyptus populnea</i>	Poplar Box	20 x 5m
<i>Lophostemon confertus</i>	Queensland Brush Box	15 x 10m

SHRUBS, GROUNDCOVERS AND GRASSES

<i>Banksia robur</i>	Swamp Banksia	2 x 2m
Grevillea	'Bronze Rambler'	0.5 x 5m
<i>Grevillea rosemarinifolia</i> 'Crimson Villea'	Crimson Villea	0.8 x 0.8m
<i>Leptospermum polygalifolium</i>	Tea Tree	4 x 3m
<i>Lomandra fluviatilis</i> 'Shara'	Shara	0.5 x 0.5m
<i>Lomandra labill</i> 'Evergreen Baby'	Evergreen Baby	0.45 x 0.45m
<i>Lomandra multiflora</i> 'Frilly Lace'	Frilly Lace	0.45 x 0.45m
<i>Melaleuca linariifolia</i>	Claret Tops	1.2 x 1m
<i>Poa labillardieri</i>	Common Tussock-grass	1.2 x 0.5m
<i>Syzygium australe</i>	Brush cherry	5 x 2m

Note:
Refer engineering drawings for detailed information

- 01 GROUNDCOVERS (Refer plant palette)
Eg Grevillea bronze Rambler
- 02 GRASSES (Refer plant palette)
Eg Lomandra Shara, Poa Tlabillardieri
- 03 SMALLER SHRUBS (Refer plant palette)
Eg Banksia robur, Melaleuca Claret Tops, Grevillea Crimson Villea
- 04 SCREENING SHRUBS (Refer plant palette)
Eg Leptospermum polygolifolim, Syzygium australe
- 05 LOWER LEVEL TREES (Refer plant palette)
Eg Cupaniopsis anacardioides, Lophostemon confertus
- 06 CANOPY TREES (Refer plant palette)
Eg Corymbia citriodora, Eucalyptus populnea



4.5 Planting Batter to Austons Lane

Note:
Refer engineering drawings for detailed information



- 01 Planting batter with low maintenance native planting species
- 02 Screening trees
- 03 1.8m high good neighbour fence
- 04 Existing trees to be retained (indicative only)
Individual treatment may be required in front of specific lots



VEGETATION BUFFER - PRECEDENT IMAGE



4.6 Planting Batter to James Creek Road

Note:
Refer engineering drawings for detailed information



Section B - Planting Batter to James Creek Road

- 01 Planting batter with low maintenance native planting species
- 02 Screening trees
- 03 Feature fence

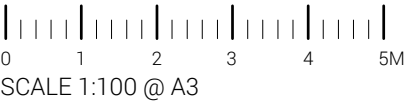



05

PLANTING

PLANTING

5.1 Planting Palette - Street

Botanical Name	Common Name
<i>Cupaniopsis anacardioides</i>	Tuckeroo
<i>Tristaniopsis laurina</i>	Kanooka Gum
<i>Waterhousea floribunda</i>	Weeping Lilly Pilly

TREES



Tristaniopsis laurina
Kanooka Gum



Waterhousea floribunda
Weeping Lilly Pilly



Cupaniopsis anacardioides
Tuckeroo

Botanical Name	Common Name
<i>Acmena smithii</i> 'Allyn Magic'	Allyn Magic
<i>Callistemon viminalis</i> 'little john'	Little John
<i>Crinum pedunculatum</i>	Swamp lily
<i>Dianella caerulea</i>	Blue Flax Lily
<i>Lomandra hystrix</i> 'Katie Belles'	Katie Belles
<i>Lomandra longifolia</i> 'Nyalla'	Nyalla
<i>Myoporum ellipticum</i>	Coastal Boobialla
<i>Syzygium australe</i>	Brush cherry
<i>Westringia hybrid</i> 'Blue Gem'	Blue Gem
<i>Westringia fruticosa</i> 'Mundi'	Mundi

SHRUB & GROUND COVER



Acmena smithii 'Allyn Magic'
Allyn Magic



Syzygium australe
Brush cherry



Callistemon viminalis 'little john'
Little John



Westringia fruticosa 'Mundi'
Mundi



Westringia hybrid 'Blue Gem'
Blue Gem



Dianella caerulea
Blue Flax Lily



Lomandra longifolia 'Nyalla'
Nyalla



Lomandra hystrix 'Katie Belles'
Katie Belles



Crinum pedunculatum
Swamp lily



Myoporum ellipticum
Coastal Boobialla

PLANTING

5.2 Planting Palette - Park Trees

Botanical Name	Common Name
<i>Corymbia citriodora</i>	Spotted Gum
<i>Ficus brachypoda</i>	Edible fig
<i>Ficus microcarpa</i>	Indian Laurel Fig
<i>Leptospermum petersonii</i>	Lemon-scented Tea Tree
<i>Lophostemon confertus</i>	Queensland Brush Box
<i>Syzygium oleosum</i>	Blue Lilly Pilly
<i>Tristaniopsis laurina</i>	Kanooka Gum

TREES



Corymbia citriodora
Spotted Gum



Ficus brachypoda
Edible fig



Ficus microcarpa
Indian Laurel Fig



Tristaniopsis laurina
Kanooka Gum



Syzygium oleosum
Blue Lilly Pilly



Leptospermum petersonii
Lemon-scented Tea Tree



Lophostemon confertus
Queensland Brush Box

PLANTING

5.3 Planting Palette - Park Shrub & Groundcover

Botanical Name	Common Name
<i>Austromyrtus dulcis</i>	Midgen berry
<i>Banksia robur</i>	Swamp Banksia
<i>Callistemon viminalis 'little john'</i>	Little John
<i>Hovea longifolia</i>	Hovea purple bush pea
<i>Leptospermum 'Pink Cascade'</i>	Pink Cascade
<i>Leptospermum polygalifolium</i>	Tea Tree
<i>Lomandra hystrix 'Katie Belles'</i>	Katie Belles
<i>Syzygium australe</i>	Brush cherry
<i>Westringia hybrid 'Blue Gem'</i>	Blue Gem

SHRUB & GROUNDCOVER



Syzygium australe
Brush cherry



Banksia robur
Swamp Banksia



Callistemon viminalis 'little john'
Little John



Lomandra hystrix 'Katie Belles'
Katie Belles



Westringia hybrid 'Blue Gem'
Blue Gem



Hovea longifolia
Hovea purple bush pea



Leptospermum polygalifolium
Tea Tree



Leptospermum 'Pink Cascade'
Pink Cascade



Austromyrtus dulcis
Midgen berry



Melaleuca linariifolia
Claret Tops

5.4 Planting Palette - Southern Batter to Austons Lane

Botanical Name	Common Name	TREES
<i>Corymbia citriodora</i>	Spotted Gum	
<i>Cupaniopsis anacardioides</i>	Tuckeroo	
<i>Eucalyptus populnea</i>	Poplar Box	
<i>Lophostemon confertus</i>	Queensland Brush Box	



Corymbia citriodora
Spotted Gum



Cupaniopsis anacardioides
Tuckeroo



Eucalyptus populnea
Poplar Box



Lophostemon confertus
Queensland Brush Box

Botanical Name	Common Name	SHRUB & GROUNDCOVER
<i>Banksia robur</i>	Swamp Banksia	
Grevillea	'Bronze rambler'	
<i>Grevillea rosemarinifolia</i> 'Crimson Villea'	Crimson Villea	
<i>Leptospermum polygalifolium</i>	Tea Tree	
<i>Lomandra fluviatilis</i> 'Shara'	Shara	
<i>Lomandra labill</i> 'Evergreen Baby'	Evergreen Baby	
<i>Lomandra multiflora</i> 'Filly Lace'	Filly Lace	
<i>Melaleuca linariifolia</i>	Claret Tops	
<i>Poa labillardieri</i>	Common Tussock-grass	
<i>Syzygium australe</i>	Brush cherry	



Banksia robur
Swamp Banksia



Grevillea
'Bronze rambler'



Grevillea rosemarinifolia 'Crimson Villea'
Crimson Villea



Leptospermum polygalifolium
Tea Tree



Lomandra fluviatilis 'Shara'
Shara



Lomandra labill 'Evergreen Baby'
Evergreen Baby



Lomandra multiflora 'Filly Lace'
Filly Lace



Melaleuca linariifolia
Claret Tops



Poa labillardieri
Common Tussock-grass



Syzygium australe
Brush cherry

PLANTING

5.5 Planting Palette - Bio Basin

Botanical Name	Common Name	TREES
<i>Melaleuca linariifolia</i>	Paperbark	



Melaleuca linariifolia
Paperbark

Botanical Name	Common Name	SHRUB & GROUND COVER
<i>Baloskion tetraphyllum</i>	tassel rope-rush	
<i>Dianella longifolia</i> var <i>longifolia</i>	Pale Flax-lily	
<i>Lomandra hystrix</i> 'Katie Belles'	Katie Belles	
<i>Lomandra longifolia</i> 'Katrinus Deluxe'	Katrinus Deluxe	
<i>Pennisetum alopecuroides</i> 'Purple Lea'	Purple Lea	
<i>Lomandra fluviatilis</i> 'Shara'	Shara	
<i>Banksia robur</i>	Swamp Banksia	
<i>Carex appressa</i>	Tall Sedge	
<i>Carex fascicularis</i>	Tassel Sedge	
<i>Ficinia nodosa</i>	Knobby Club Rush	



Baloskion tetraphyllum
tassel rope-rush



Dianella longifolia var *longifolia*
Pale Flax-lily



Lomandra hystrix 'Katie Belles'
Katie Belles



Lomandra longifolia 'Katrinus Deluxe'
Katrinus Deluxe



Pennisetum alopecuroides 'Purple Lea'
Purple Lea



Lomandra fluviatilis 'Shara'
Shara



Banksia robur
Swamp Banksia



Carex appressa
Tall Sedge



Carex fascicularis
Tassel Sedge



Ficinia nodosa
Knobby Club Rush

5.6 Planting Palette - Bushfire Protection Zone Trees

Botanical Name	Common Name	TREES
<i>Acacia decurrens</i>	Black Wattle	
<i>Brachychiton populneus</i>	Kurrajong	
<i>Corymbia maculata</i>	Spotted gum	
<i>Cupaniopsis anacardioides</i>	Tuckeroo	
<i>Elaeocarpus eumundi</i>	Eumundi quandong	
<i>Fraxinus griffithii</i>	Griffith's Ash	
<i>Gleditsia triacanthos 'Sunburst'</i>	Sunburst Honeylocust	
<i>Lagerstroemia indica</i>	Crepe myrtle	
<i>Magnolia grandiflora 'Teddy bear'</i>	Bull Bay Magnolia	



Acacia decurrens
Black Wattle



Brachychiton populneus
Kurrajong



Corymbia citriodora
Spotted Gum



Cupaniopsis anacardioides
Tuckeroo



Elaeocarpus eumundi
Eumundi quandong



Fraxinus griffithii
Griffith's Ash



Gleditsia triacanthos 'Sunburst'
Sunburst Honeylocust



Lagerstroemia indica
Crepe myrtle



Magnolia grandiflora 'Teddy bear'
Bull Bay Magnolia

5.7 Planting Palette - Bushfire Protection Zone Shrub & Groundcover

Botanical Name	Common Name
<i>Acacia acinacea</i>	Gold Dust Wattle
<i>Carpobrotus glaucescens</i> 'Aussie Rambler'	Pigface
<i>Casuarina glauca</i> 'Freefall'	Groundcover sheoak
<i>Liriope muscari</i> 'Evergreen Giant'	Lilyturf
<i>Lomandra longifolia</i> 'Nyalla'	Spiny Headed Mat Rush
<i>Leptospermum polygalifolium</i>	Tea Tree
<i>Lomandra hystrix</i> 'Katie Belles'	Katie Belles
<i>Lomandra longifolia</i> 'Katrinus deluxe'	Spiny Headed Mat Rush
<i>Myoporum parvifolium</i>	Creeping boobialla
<i>Syzygium australe</i>	Lilly Pilly

SHRUB & GROUNDCOVER



Acacia acinacea
Gold Dust Wattle



Carpobrotus glaucescens 'Aussie Rambler'
Pigface



Casuarina glauca 'Freefall'
Groundcover sheoak



Liriope muscari 'Evergreen Giant'
Lilyturf



Lomandra longifolia 'Nyalla'
Spiny Headed Mat Rush



Leptospermum polygalifolium
Tea Tree



Lomandra hystrix 'Katie Belles'
Katie Belles



Lomandra longifolia 'Katrinus deluxe'
Spiny Headed Mat Rush



Myoporum parvifolium
Creeping boobialla



Syzygium australe
Lilly Pilly



06

APPENDIX

6.1 Site Survey

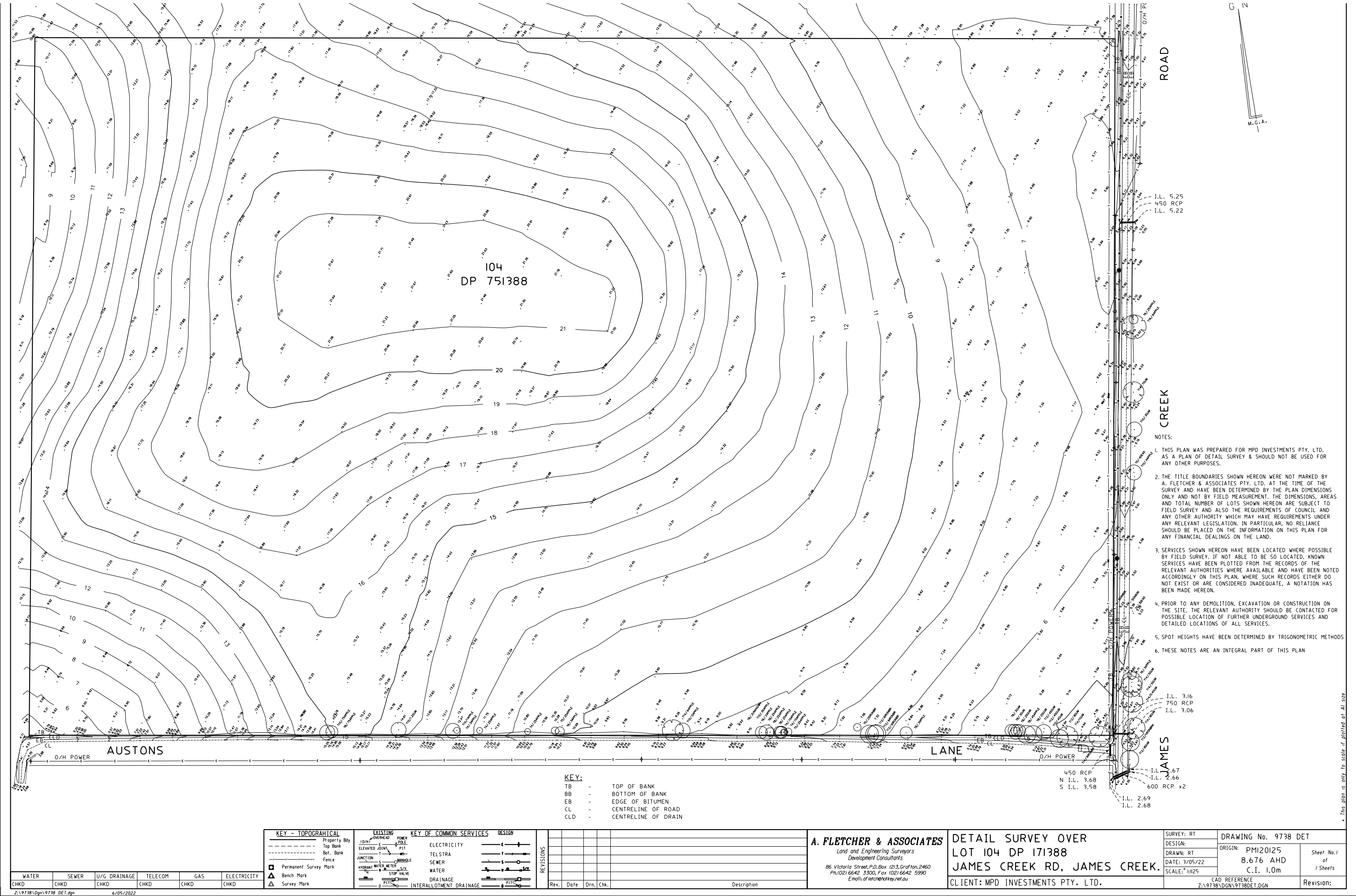



place
design
group.